



# Accessories

For **LH** Series

- Rack Cover .....D-38
- Dog .....D-41
- CR Circuit for Surge Suppression .....D-41

# For Linear Head LH Series Rack Cover

Rack covers protect the linear head rack from dust. When installing rack covers on both sides of the linear head a supplemental rack cover must also be purchased.



**F Type**  
(Vertical Stroke Type)



**B Type**  
(Horizontal Stroke Type)

**F Type**

● **Dimensions** Unit = inch (mm)

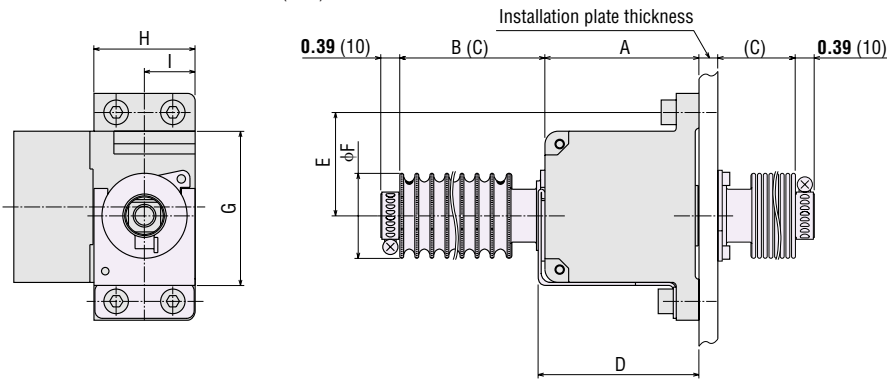

Material  
Rack Cover: Nylon  
Installation Fittings: SPCC  
Accessories: Installation fittings, stainless steel band

**Linear head installation plate.**

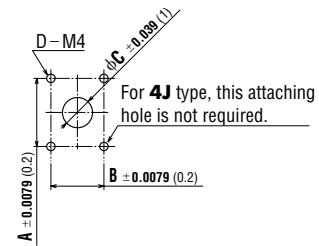

**Notes:**

- When a rack cover is installed, the effective rack stroke is shortened. Refer to the table below for the operable stroke.
- The installation fittings are fastened together with the main unit using screws (sold separately) :  
**2JF** type: M6; **4JF** type: M8; **5JF** type: M10
- When installing the rack cover, drill installation holes in the linear head installation plate using the diagram on the right for reference, then fasten with screws at the rack cover flange.  
Screws must be purchased separately.

Model	A	B	φC	D
<b>2JF-□A2</b>	1.42(36)	1.10(28)	0.91(23)	4
<b>4JF-□A2</b>	1.54(39)	1.54(39)	1.26(32)	3
<b>5JF-□A</b>	1.69(43)	1.69(43)	1.57(40)	4

Unit = inch (mm)

Model	Applicable Linear Head	A	For Single Sided Rack Cover		For Dual Sided Rack Covers*		D	E	φF	G	H (Fitting Width)	I
			B	Operable Stroke	(C)	Operable Stroke						
<b>2JF-1A2</b>	<b>2LF□N-1</b>	2.61 (66.3)	0.98~3.94 (25~100)	2.95 (75)	0.98~2.52 (25~64)	1.54 (39)	2.76 (70)	1.47 (37.3)	1.65 (42)	2.41 (61.2)	1.57 (40)	0.79 (20)
<b>2JF-2A2</b>	<b>2LF□N-2</b>		1.57~7.87 (40~200)	6.30 (160)	1.57~5.51 (40~140)	3.94 (100)						
<b>2JF-3A2</b>	<b>2LF□N-3</b>		2.36~11.81 (60~300)	9.45 (240)	2.36~8.66 (60~220)	6.30 (160)						
<b>4JF-1A2</b>	<b>4LF□N-1</b>	3.23 (82)	1.57~3.94 (40~100)	2.36 (60)	1.57~1.89 (40~48)	0.31 (8)	3.38 (85.9)	2.15 (54.7)	1.77 (45)	3.21 (81.6)	2.11 (53.6)	1.06 (26.8)
<b>4JF-2A2</b>	<b>4LF□N-2</b>		2.17~7.87 (55~200)	5.71 (145)	2.17~5.31 (55~135)	3.15 (80)						
<b>4JF-3A2</b>	<b>4LF□N-3</b>		2.36~11.81 (60~300)	9.45 (240)	2.36~8.98 (60~228)	6.61 (168)						
<b>4JF-4A2</b>	<b>4LF□N-4</b>		3.15~15.75 (80~400)	12.60 (320)	3.15~12.20 (80~310)	9.06 (230)						
<b>4JF-5A2</b>	<b>4LF□N-5</b>		3.94~19.69 (100~500)	15.75 (400)	3.94~15.31 (100~389)	11.38 (289)						
<b>5JF-1A</b>	<b>5LF□U-1</b>	3.74 (95)	0.98~3.94 (25~100)	2.95 (75)	1.26~3.94 (32~100)	2.68 (68)	3.90 (99.1)	2.48 (63.1)	1.77 (45)	3.61 (91.6)	2.13 (54)	1.18 (30)
<b>5JF-2A</b>	<b>5LF□U-2</b>		1.57~7.87 (40~200)	6.30 (160)	1.57~7.60 (40~193)	6.02 (153)						
<b>5JF-3A</b>	<b>5LF□U-3</b>		2.36~11.81 (60~300)	9.45 (240)	2.36~10.75 (60~273)	8.39 (213)						
<b>5JF-4A</b>	<b>5LF□U-4</b>		3.15~15.75 (80~400)	12.60 (320)	3.15~13.94 (80~354)	10.79 (274)						
<b>5JF-5A</b>	<b>5LF□U-5</b>		3.94~19.69 (100~500)	15.75 (400)	3.94~17.09 (100~434)	13.15 (334)						

\* When rack covers are used on both sides, the "operable stroke" and "C" are values when a 0.39 inch (10 mm) thick installation plate is used.

**B Type**

● **Dimensions** Unit = inch (mm)

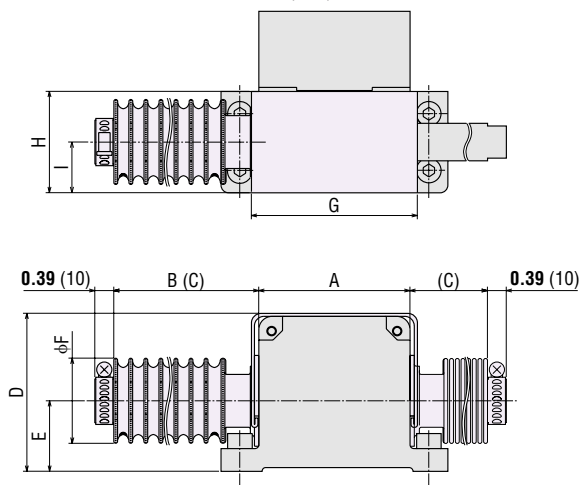

**Material**

Rack cover: Nylon

Installation Fittings: SPCC

Accessories: Installation Fittings, Plugs, stainless steel band

**Note:**

- When a rack cover is installed, the effective rack stroke is shortened. Refer to the table below for the operable stroke.

Unit = inch (mm)

Model	Applicable Linear Head	A	For Single Sided Rack Cover		For Dual Sided Rack Covers*		D	E	φF	G	H (Fitting Width)	I
			B	Operable Stroke	(C)	Operable Stroke						
<b>2JB-1A2</b>	<b>2LB□N-1</b>	2.36 (60)	0.98~3.94 (25~100)	2.95 (75)	0.98~2.76 (25~70)	1.77 (45)	2.66 (67.5)	1.42 (36)	1.65 (42)	2.67 (67.9)	1.57 (40)	0.79 (20)
<b>2JB-2A2</b>	<b>2LB□N-2</b>		1.57~7.87 (40~200)	6.30 (160)	1.57~4.57 (40~116)	2.99 (76)						
<b>2JB-3A2</b>	<b>2LB□N-3</b>		2.36~11.81 (60~300)	9.45 (240)	2.36~9.33 (60~237)	6.97 (177)						
<b>4JB-1A2</b>	<b>4LB□N-1</b>	3.15 (80)	1.57~3.94 (40~100)	2.36 (60)	1.57~2.36 (40~60)	0.79 (20)	3.29 (83.6)	1.47 (37.3)	1.77 (45)	3.46 (87.8)	2.11 (53.6)	1.06 (26.8)
<b>4JB-2A2</b>	<b>4LB□N-2</b>		2.17~7.87 (55~200)	5.71 (145)	2.17~5.79 (55~147)	3.62 (92)						
<b>4JB-3A2</b>	<b>4LB□N-3</b>		2.36~11.81 (60~300)	9.45 (240)	2.36~9.45 (60~240)	7.09 (180)						
<b>4JB-4A2</b>	<b>4LB□N-4</b>		3.15~15.75 (80~400)	12.60 (320)	3.15~12.68 (80~322)	9.53 (242)						
<b>4JB-5A2</b>	<b>4LB□N-5</b>		3.94~19.69 (100~500)	15.75 (400)	3.94~15.79 (100~401)	11.85 (301)						
<b>5JB-1A</b>	<b>5LB□U-1</b>	3.54 (90)	0.98~3.94 (25~100)	2.95 (75)	1.85~3.94 (47~100)	2.05 (52)	3.80 (96.6)	2.17 (55.2)	1.77 (45)	3.89 (98.7)	2.13 (54)	1.18 (30)
<b>5JB-2A</b>	<b>5LB□U-2</b>		1.57~7.87 (40~200)	6.30 (160)	1.89~7.87 (48~200)	5.94 (151)						
<b>5JB-3A</b>	<b>5LB□U-3</b>		2.36~11.81 (60~300)	9.45 (240)	2.36~11.34 (60~288)	8.98 (228)						
<b>5JB-4A</b>	<b>5LB□U-4</b>		3.15~15.75 (80~400)	12.60 (320)	3.15~14.53 (80~369)	11.38 (289)						
<b>5JB-5A</b>	<b>5LB□U-5</b>		3.94~19.69 (100~500)	15.75 (400)	3.94~17.68 (100~449)	13.74 (349)						

\* When rack covers are used on both sides, the "operable stroke" and "C" are values when a 0.39 inch (10 mm) thick installation plate is used.

## ■ Supplemental Rack Cover

When rack covers are installed on both sides of the rack, a supplemental rack cover must also be purchased.

### ● Rack Cover Dimensions Unit = inch (mm)

For **2L** Type

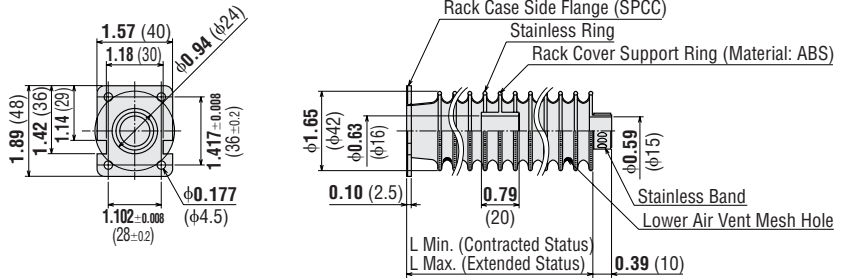

Model	L max (Extended Status)	L min (Contracted Status)	Number of Support Rings	Compression Ratio	Weight lb. (kg)
<b>2J-1A2</b>	3.94 (100)	0.98 (25)	0	1/4	0.099 (0.045)
<b>2J-2A2</b>	7.87 (200)	1.57 (40)	1	1/5	0.132 (0.060)
<b>2J-3A2</b>	11.81 (300)	2.36 (60)	1	1/5	0.154 (0.070)

For **4L** Type

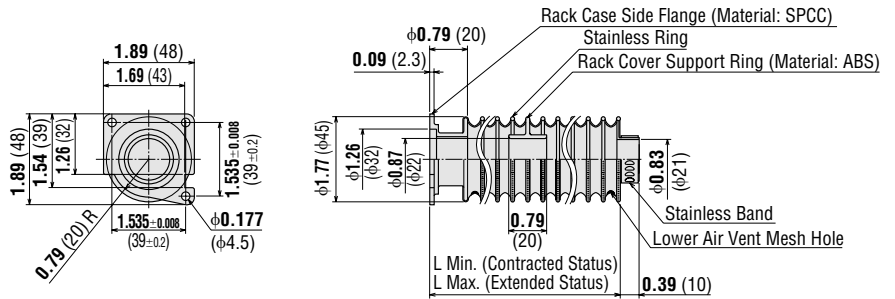

Model	L max (Extended Status)	L min (Contracted Status)	Number of Support Rings	Compression Ratio	Weight lb. (kg)
<b>4J-1A2</b>	3.94 (100)	1.57 (40)	0	1/2.5	0.066 (0.030)
<b>4J-2A2</b>	7.87 (200)	2.17 (55)	1	1/3.6	0.099 (0.045)
<b>4J-3A2</b>	11.81 (300)	2.36 (60)	1	1/5	0.121 (0.055)
<b>4J-4A2</b>	15.75 (400)	3.15 (80)	2	1/5	0.154 (0.070)
<b>4J-5A2</b>	19.69 (500)	3.94 (100)	3	1/5	0.198 (0.090)

For **5L** Type

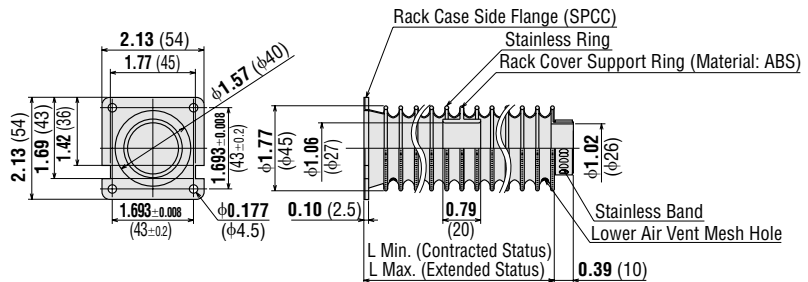

Model	L max (Extended Status)	L min (Contracted Status)	Number of Support Rings	Compression Ratio	Weight lb. (kg)
<b>5J-1A</b>	3.94 (100)	0.98 (25)	0	1/4	0.110 (0.050)
<b>5J-2A</b>	7.87 (200)	1.57 (40)	1	1/5	0.154 (0.070)
<b>5J-3A</b>	11.81 (300)	2.36 (60)	1	1/5	0.176 (0.080)
<b>5J-4A</b>	15.75 (400)	3.15 (80)	2	1/5	0.209 (0.095)
<b>5J-5A</b>	19.69 (500)	3.94 (100)	3	1/5	0.253 (0.115)

## For Linear Head LH Series Dog

Dogs should be positioned on the rack to establish a stop or reverse point along the rack.

● **Dimensions** Scale 1/4, Unit = inch (mm)

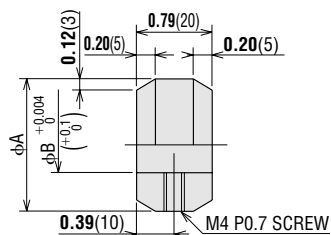

Linear Head Model	Dog Model	$\phi A$	$\phi B$
For <b>0L</b> type	<b>LXD0C</b>	0.71 (18)	0.315 (8)
For <b>2L</b> type	<b>LXD2C</b>	0.94 (24)	0.543 (13.8)
For <b>4L</b> type	<b>LXD4C</b>	1.18 (30)	0.780 (19.8)
For <b>5L</b> type	<b>LXD5C</b>	1.38 (35)	0.976 (24.8)

## For Linear Head LH Series CR Circuit for Surge Suppression

This circuit is used to protect the contacts of the relay and/or switch used to control the motor direction.

Model: **EPCR1201-2**  
250 VAC (120 $\Omega$ , 0.1 $\mu$ F)

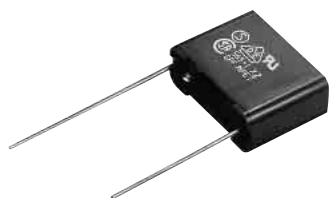

● **Dimensions** Scale 1/2, Unit = inch (mm) Weight: 0.18 oz. (5 g)

